

Spare part list
Electromagnetic Spring-Set-Brake
Series SFB 6,3



Please supply the following details when ordering spare parts:

- Dimension of the brake (type)
- Brake serial number
- Description of the spare part
- Quantity required
- Id.-No. of the spare part

Type, serial number of the brake and the coil voltage are specified on the rating plate.

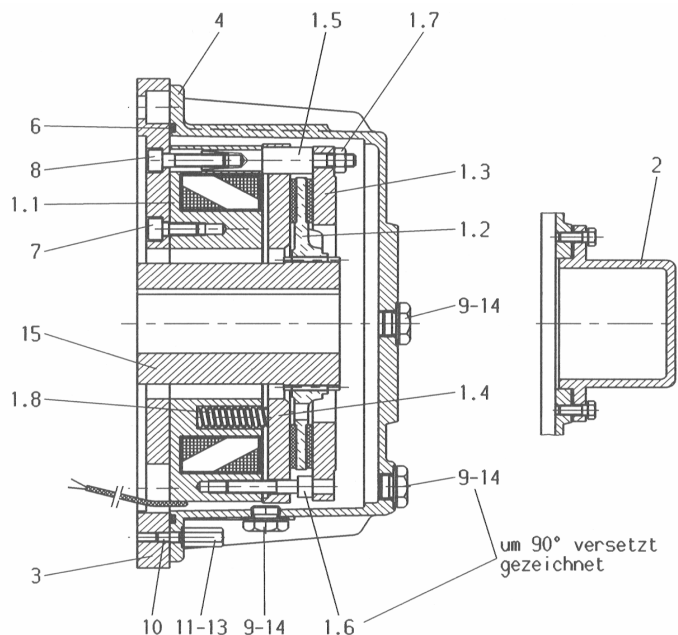

Rating plate

PINTSCH BAMAG	
D I N S L A K E N	
Bremse/Brake	<input type="text"/>
Moment/Torque	<input type="text"/> Nm
<input type="text"/> V DC	<input type="text"/> A <input type="text"/> W
Luftspalt/Airgap	<input type="text"/> norm
Airgap	Off <input type="text"/> max
Nr./No.	<input type="text"/>
Baujahr/Built	<input type="text"/>
Prüfung/Test	<input type="text"/>
CE	

)*	pos.	description	qty.	dimension / standard	Kg/piece	P.B. Id.-No.
X	1.1.1	coil body group 110V DC	1	D=170 D=64 x 36 110V DC	4,55	000 599 100-214
X	1.1.2	coil body group		D=170 D=64 x 36	4,55	type specific
	1.2	friction lining group	1	D 141/d 56 x 15 19z	0,40	000 599 200-214
	1.3	brake flange	1	D 170/d 90 x 10,5	1,03	000 599 800-214
X	1.4.1	armature plate	1	D 172/d 64 x 12,5	1,80	000 599 400-214
X	1.4.2	armature plate group f. 1 MS/PS		D 172/d 64 x 12,5	1,80	001 193 300-214
X	1.4.3	armature plate group f. 2 MS/PS		D 172/d 64 x 12,5	1,80	001 143 900-214
	1.5	bolt	4	D 11x 69 M8	0,04	000 615 400-214
	1.6	socket head screw	2	M 8 x 35 DIN 912 L.W.		031 411 800-000
	1.7	self-locking hexagon nut	4	VM 8 DIN 980		035 075 769-000
	1.8	pressure spring	14	D 8 x 36		047 010 008-004
	2.0	cover group	1	D 120 x 65		269 300 004-000
X	3.0.1	adaptor flange	1	standard flange A250	5,20	000 599 600-214
X	3.0.2			standard flange A300	7,70	000 599 700-214
X	3.0.3			special flange		type specific
X	4.0.1	housing	1	D 238 x 106	5,40	000 615 300-214
X	4.0.2			special housing		type specific
	6	O-ring	1	179 x 3		042 572 235-000
	7	socket head screw	4	M 6 x 12 DIN 912		031 411 096-000
	8	socket head screw	4	M 6 x 25 DIN 912		031 411 502-000
	9	lock bolt	6	AM 16 x 1,5 DIN 7604		032 410 210-000
	10	stud	6	M6 x 16 DIN 939		033 020 473-001
	11	cup nut	6	M6 x 22		035 620 955-000
	13	washer	6	A6 x 10 DIN 7603		042 524 024-000
	14	washer	6	A16 x 20 DIN 7603		042 524 064-000
	15.1	hub (pinion)	1	rough drilled D=26	1,20	000 598 500-214
	15.2	hub (pinion)		standard cylindrical		type specific

)*: For ordering spare parts marked with X, please specify the serial number of the brake printed on the rating plate.

Note: Positions with three digits (f.e. 1.2.3) are possible variants. The installed variant depends on the type of the brake.

Additional equipment: To order spare parts for additional equipment like side-fitting connection box, micro- or proximity switch, it is necessary to specify the serial number of the brake.

Datum 26.09.2003	erstellt EVA / Thonen	geprüft EVA / Tho	genehmigt	a00 598 900-958
---------------------	--------------------------	----------------------	-----------	------------------------