

Spare part list
Electromagnetic Spring-Set-Brake
Series SFB 10



Please supply the following details when ordering spare parts:

- Dimension of the brake (type)
- Brake serial number
- Description of the spare part
- Quantity required
- Id.-No. of the spare part

Type, serial number of the brake and the coil voltage are specified on the rating plate.

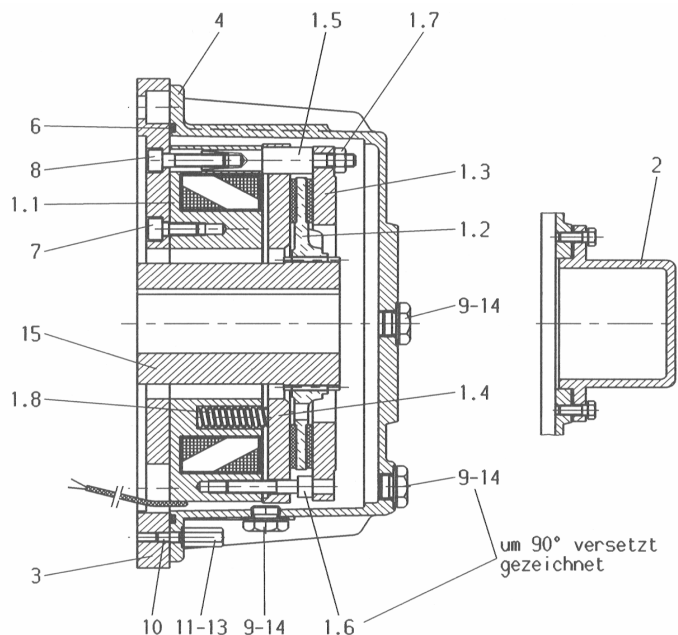

Rating plate

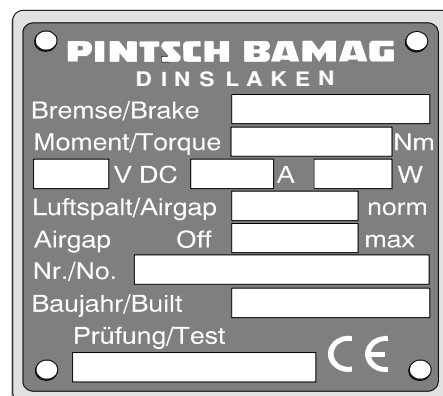

)*	pos.	description	qty.	dimension / standard	Kg/piece	P.B. Id.-No.
X	1.1.1	coil body group 110V DC	1	D=198 D=72 x 43 110V DC	7,64	000 597 600-214
X	1.1.2	coil body group		D=198 D=72 x 43	7,64	type specific
	1.2	friction lining group	1	D 165/d 56 x 18 19z	0,60	000 597 700-214
	1.3	brake flange	1	D 198/d 107 x 12	1,70	000 598 200-214
X	1.4.1	armature plate	1	D 201/d 72 x 13,5	2,70	000 597 900-214
X	1.4.2	armature plate group f. 1 MS/PS		D 201/d 72 x 13,5	2,70	001 211 100-214
X	1.4.3	armature plate group f. 2 MS/PS		D 201/d 72 x 13,5	2,70	
	1.5	bolt	4	D 14x 84,5 M8	0,06	000 598 400-214
	1.6	socket head screw	2	M 8 x 35 DIN 912 L.W.		031 411 800-000
	1.7	self-locking hexagon nut	4	VM 8 DIN 980		035 075 769-000
	1.8	pressure spring	12	D 11 x 36		047 010 011 005
	2.0	cover group	1	D 120 x 65		269 300 004-000
X	3.0.1	adaptor flange	1	standard flange A300	7,60	000 598 100-214
X	3.0.2			standard flange A350	11,80	000 602 700-214
X	3.0.3			special flange		type specific
X	4.0.1	housing	1	D 260 x 109	7,00	000 598 800-214
X	4.0.2			special housing		type specific
	6	O-ring	1	210 x 4		042 572 360-000
	7	socket head screw	8	M 8 x 20 DIN 912		031 411 126-000
	8					
	9	lock bolt	6	AM 16 x 1,5 DIN 7604		032 410 210-000
	10	stud	6	M6 x 16 DIN 939		033 020 473-001
	11	cup nut	6	M6 x 22		035 620 955-000
	13	washer	6	A6 x 10 DIN 7603		042 524 024-000
	14	washer	6	A16 x 20 DIN 7603		042 524 064-000
	15.1	hub (pinion)	1	rough drilled D=26	1,20	000 598 500-214
	15.2	hub (pinion)		standard cylindrical		type specific
	16	anti condensation heater	1	230V AC		001 071 700-249

)*: For ordering spare parts marked with X, please specify the serial number of the brake printed on the rating plate.

Note: Positions with three digits (f.e. 1.2.3) are possible variants. The installed variant depends on the type of the brake.

Additional equipment: To order spare parts for additional equipment like side-fitting connection box, micro- or proximity switch, it is necessary to specify the serial number of the brake.

Datum 16.12.2003	erstellt EVA / Thonen	geprüft EVA / Tho	ÄM-Nr. A / 4-Tho03103	a00 597 400-958
---------------------	--------------------------	----------------------	--------------------------	------------------------