

Spare part list
Electromagnetic Spring-Set-Brake
Series SFB 16



Please supply the following details when ordering spare parts:

- Dimension of the brake (type)
- Brake serial number
- Description of the spare part
- Quantity required
- Id.-No. of the spare part

Type, serial number of the brake and the coil voltage are specified on the rating plate.

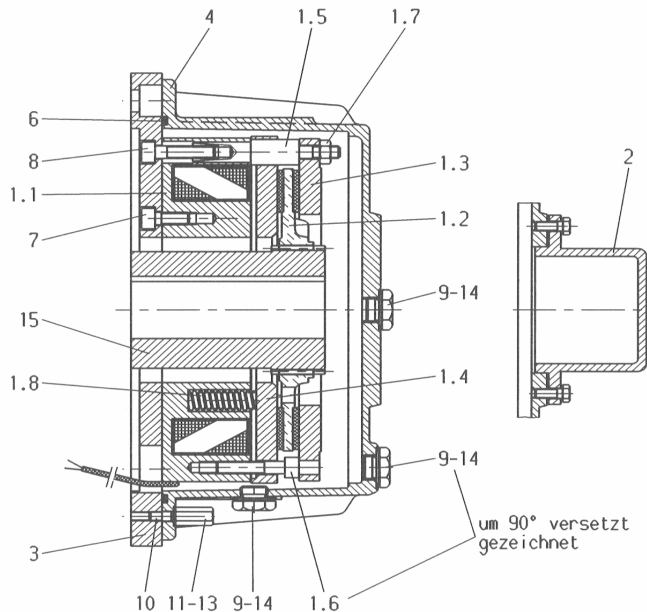

Rating plate

PINTSCH BAMAG	
DINSLAKEN	
Bremse/Brake	<input type="text"/>
Moment/Torque	<input type="text"/> Nm
<input type="text"/> V DC	<input type="text"/> A <input type="text"/> W
Luftspalt/Airgap	<input type="text"/> norm
Airgap	Off <input type="text"/> max
Nr./No.	<input type="text"/>
Baujahr/Built	<input type="text"/>
Prüfung/Test	<input type="text"/>

)*	pos.	description	quity.	dimension / standard	Kg/piece	P.B. Id.-No.
X	1.1.1	coil body group 110V DC	1	D=218 D=92 x 52 110V DC	11,30	000 596 100-214
X	1.1.2	coil body group		D=218 D=92 x 52	11,32	type specific
	1.2	friction lining group	1	D 179/d 76 x 20 19z	0,65	000 596 200-214
	1.3	brake flange	1	D 217/d 121 x 13	2,10	000 596 800-214
X	1.4.1	armature plate	1	D 220/d 92 x 15,2	3,50	000 596 400-214
X	1.4.2	armature plate group f. 1 MS/PS		D 220/d 92 x 15,2	3,50	001 198 600-214
X	1.4.3	armature plate group f. 2 MS/PS		D 220/d 92 x 15,2	3,50	001 198 700-214
	1.5	bolt	4	D 16x 86 M8	0,08	000 597 000-214
	1.6	socket head screw	2	M 8 x 35 DIN 912 L.W.		031 411 800-000
	1.7	self-locking hexagon nut	4	VM 8 DIN 980		035 075 769-000
	1.8	pressure spring	12	D 12,4 x 48		047 010 012-009
	2.0	cover group	1	D 120 x 65		269 300 004-000
X	3.0.1	adaptor flange	1	standard flange A300	11,90	000 658 700-214
X	3.0.2			standard flange A350	16,90	000 596 600-214
X	3.0.3			standard flange A400	16,50	000 596 700-214
X	3.0.4			standard flange A450	23,30	000 699 900-214
X	3.0.5			special flange		type specific
X	4.0.1	housing	1	D 280 x 128	7,50	000 597 300-214
X	4.0.2			special housing		type specific
	6	O-ring	1	228 x 4		042 572 429-000
	7	socket head screw	4	M 8 x 20 DIN 912		031 411 126-000
	8	socket head screw	4	M 8 x 35 DIN 912		031 411 532-000
	9	lock bolt	6	AM 16 x 1,5 DIN 7604		032 410 210-000
	10	stud	6	M6 x 16 DIN 939		033 020 473-001
	11	cup nut	6	M6 x 22		035 620 955-000
	13	washer	6	A6 x 10 DIN 7603		042 524 024-000
	14	washer	6	A16 x 20 DIN 7603		042 524 064-000
	15.1	hub (pinion)	1	rough drilled D=36	3,80	000 594 700-214
	15.2	hub (pinion)		standard cylindrical		type specific
	16	anti condensation heater	1	230V AC		000 792 000-214

)*: For ordering spare parts marked with X, please specify the serial number of the brake printed on the rating plate.

Note: Positions with three digits (f.e. 1.2.3) are possible variants. The installed variant depends on the type of the brake.

Additional equipment: To order spare parts for additional equipment like side-fitting connection box, micro- or proximity switch, it is necessary to specify the serial number of the brake.

Datum 21.12.2004	erstellt EVA / Thonen	geprüft EVA / Tho	ÄM-Nr. B / 4-Tho04077	a00 595 900-958
---------------------	--------------------------	----------------------	--------------------------	------------------------